



匯統國際股份有限公司

Huey Tung International Co., Ltd.

# 產品規格書

# Specification

[ Model : HT-NS2840F4 / 2012.11.27 version ]



**Cara Audio Corporation**

No.69, Lane 762, Dingzhong Road, Sanmin District, Kaohsiung City, Taiwan, ROC.

Tel: 886-7-310 5786 / Fax: 886-7-310 0783

E-mail: [carawang@hueytung.com.tw](mailto:carawang@hueytung.com.tw) / <http://www.hueytung.com.tw>

# 揚聲器製品規格書 SPEAKER SPECIFICATION

**型號 Model Number: HT-NS2840F4**

項目 Items		規格 Specification		
1	公称阻抗 Nominal Impedance	4Ω±15% at 1000 Hz		
2	最低共振周波数 Lowest Resonance Frequency	250 Hz±20%Hz Without a baffle		
3	实效周波数带域 Effective Frequency Range	F0~19KHz -10dB		
4	出力音压 Output Sound Pressure Level	84dB±3dB 1W/0.5M at (600,800,1K,1.2K)Hz AVE.		
5	入力 Input	定格入力 Rated input 2 W	最大入力 Maximum input 3 W	
6	磁束密度 Flux Density	-----±10% GAUSS		
7	异常音试验电压 Buzz & Rattle Test	Must be normal at sine wave 2 V		
8	动作试验电压 Operation Test	Must be normal at program source 2 V		
9	极性 Polarity	/		
10	磁石尺寸/重量 Magnet Dimension/Weight	Magnet:12.5*1.5H N35 Sub Magnet:	2.21 G	
11	连续负荷试验 Life Test	PINK noise 2 W hours		
12	耐热试验 Heat Resistance	55°C±2°C 24Hours and then room temperature 1 hours		
13	耐湿试验 Humidity Resistance	40°C±2°C 90%RH 24Hours and then room temperature 1 hours		
14	耐寒试验 Cold Resistance	/		
15	落下试验 Drop Test	1M 75°±2°		
16	绝缘耐压试验 Insulation Resistance	Or more 1MΩ 以上		
17	周波数特性 Frequency Response Curve	参照附图 On Other Drawing		
18	失真率 Distortion	10% MAX		
19	各部 材质	Cone Paper	Foam edge + Paper	
		Voice Coil	/	
		Cap	/	
20	总重量 Total Weight	/		
	Size: 13mm	Approve:	Check:	Design:
	試作發行: 2008.1.1	Arthur	Tang	LIU

DATE:03-18-2004 TIME:11:09:47

ACV = 1.000V ACZ = 3.54  $\Omega$  @ 1000Hz.  
 Start Freq. = 20Hz Stop Freq. = 10000Hz Sweep Speed: 1/24 Oct.  
 Fo = 262.0Hz; Qm = 3.16; Qe = 2.62; Qt = 1.43; DCR = 3.47 $\Omega$ .

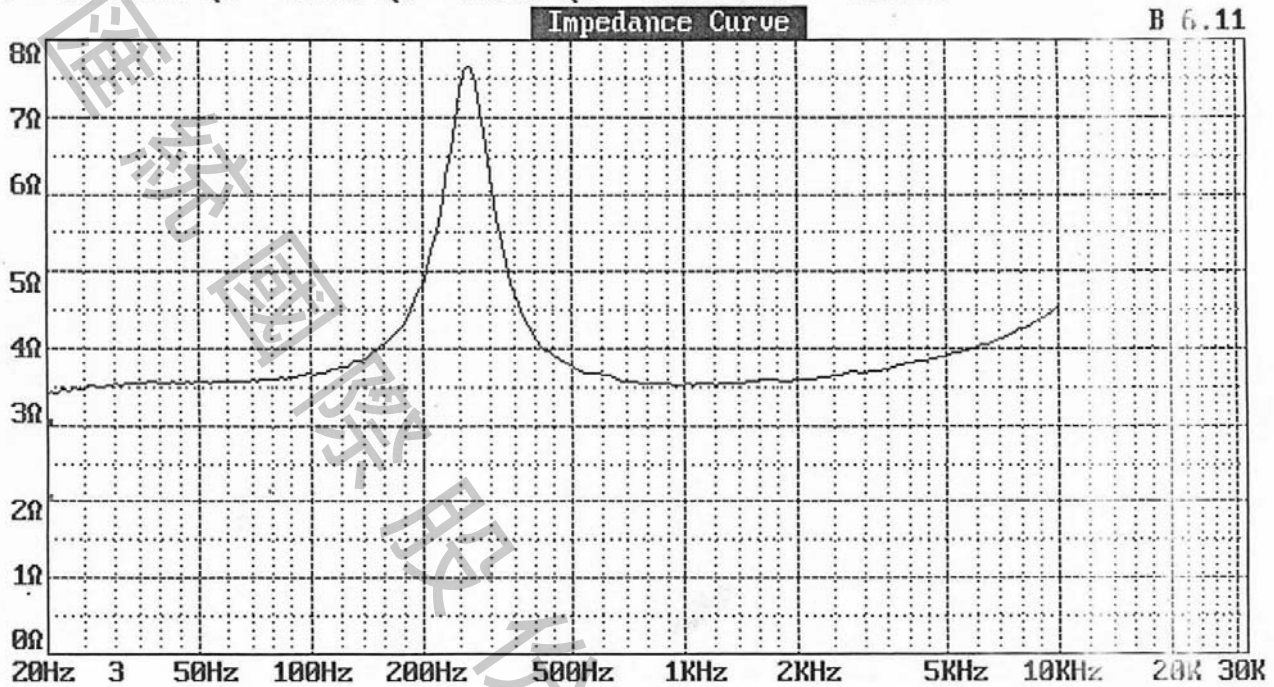

DATE:03-18-2004 TIME:11:00:31

1000Hz Sens. = 83.9dB SPL Pass F.R.: Pass DCR: 3.77 $\Omega$  Pass  
 Average SPL: 84.5dB SPL Pass (600; 800; 1000; 1200Hz) Sweep Speed: 1/12 Oct.

B 6.11

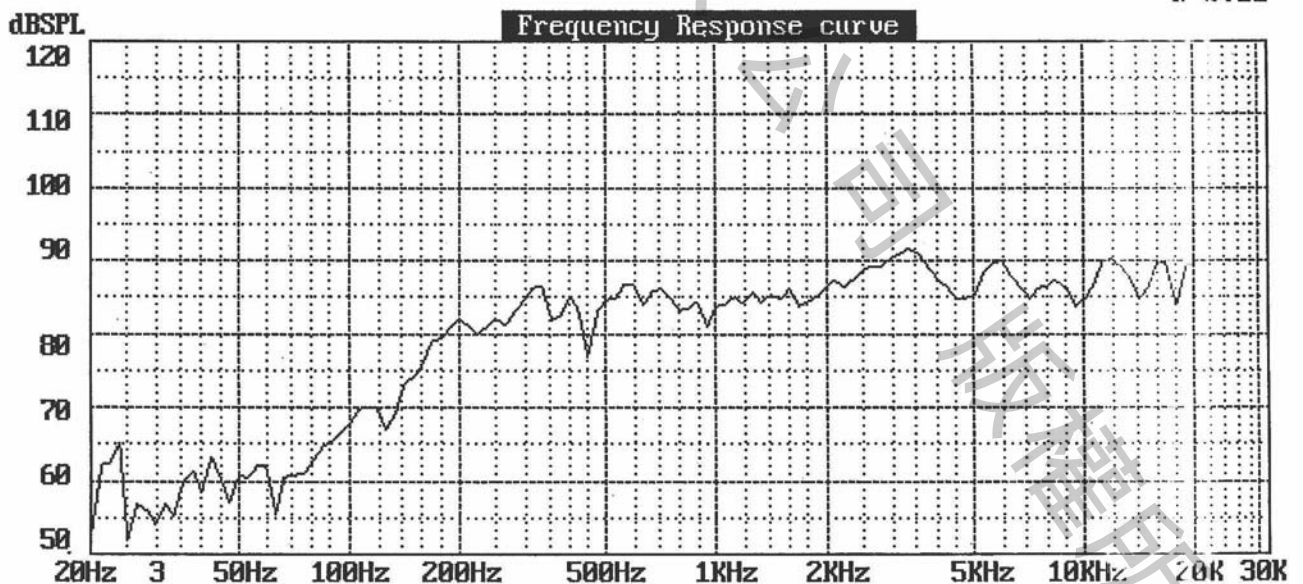

Voltage applied for **F.R.** = 2.830V **Start F.** = 20Hz **Stop F.** = 20000Hz  
 Measuring Distance = 0.50M

Mfg.:40HM 2W

Measured using Sunlight 1600;

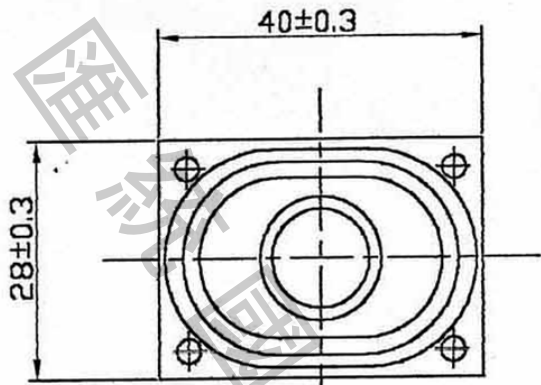

**HT-NS2840F4**

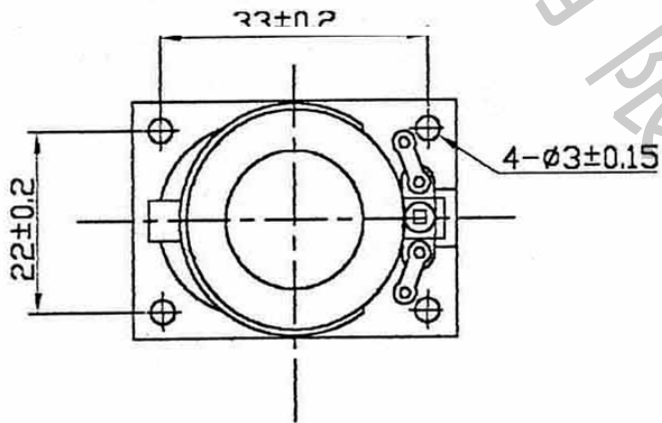
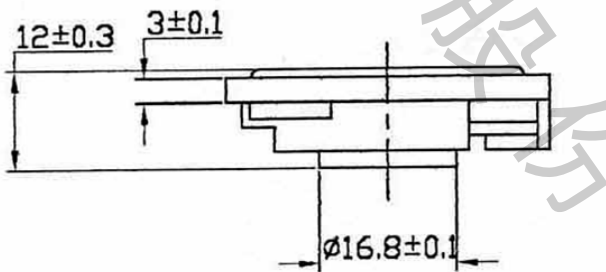

Toerance:  $\pm 0.5$

Unit:mm